

EUFORIA YACHT

[Close window](#)

SECRET LIFE



SPECIFICATIONS

Length: 45.00 metres (147' 8")
Beam: 8.70 metres (28' 7")
Draft: 2.90 metres (9' 6")
Number of crew: 10
Built: 1974
Refit: 2013
Builder: Feadship
Naval architect: De Voogt Naval Architects
Flag: British
Hull construction: Steel
Hull configuration: Displacement
 Air conditioning, Stabilisers underway, WiFi connection on board

EQUIPMENT

Engines: 2 x GM@1050hp
Cruising speed: 10
Fuel consumption: 330 Litres/Hr

ACCOMMODATION

Number of cabins: 5
Cabin configuration: 3 Double, 2 Twin, 1 Convertible
Bed configuration: 1 King, 2 Queen, 5 Single, 1 Convertible
Number of guests: 12

WATER SPORTS

Tenders + toys: 22 ft Nautica 150hp 4 strokes (Very comfortable and super fast large tender)
 4.80 Zodiac Yachtline 50hp 4 strokes
 2 Waverunners Yamaha 850 GP
 2 Paddleboards
 2 Kayaks
 Water skis, Donuts, Banana,
 Snorkelling equipment

SECRET LIFE is a classic, elegant and refined motor yacht with a great history and reputation. She is a seaworthy vessel with a great motion at sea and great stability at anchor. With a cruising speed of 10 -12 knots, a maximum speed of 14.2 knots and a long range of 3500nm from her 70 000 litre fuel tanks, she is the perfect combination of performance and luxury, which makes her the ideal yacht for cruising the Med with no need to stop and refuel.

Timeless styling, beautiful furnishings and sumptuous seating feature throughout her living areas to create an elegant and comfortable atmosphere. The yacht boasts vast deck spaces perfect for enjoying the Mediterranean sun or for socialising and entertaining with family and friends. It also makes her the ideal yacht for corporate functions. Her spacious saloon with big opening windows can be divided into 2 separate rooms with a sliding door, which can be beneficial for event charters. She also has a quiet library, and comfortable ensuite staterooms.

SECRET LIFE's accommodation together with her professional crew will make your time on board this Feadship unforgettable.

ACCOMMODATION

The Master cabin has a California king bed measuring 2m and is full width of the beam amidship, located on the lower deck. In the master suite there is a settee that can convert into a double bed (measuring 1,40m), which is where the 12th guests on board would sleep. The convertible settee area can be separated from the master cabin with a sliding door. The yacht's VIP double cabin has a 1,60m Queen bed and is located on the main deck forward, which can also transform into a cosy salon. The triple and two twin cabins are located on the lower deck and all cabins are equipped with ensuite facilities, a fridge and LCD TV with DVD and CD player.



Profile



Winter Berth - St Tropez



Sundeck



Aft Deck



Salon



Salon



Salon



Detail



Master Stateroom



Master Stateroom - Ensuite



VIP Stateroom



VIP Stateroom



Triple Cabin



Passage Way

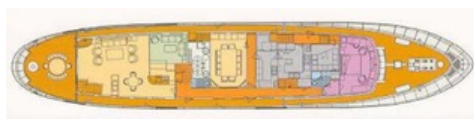

Layout



Layout

This document is not contractual. All specifications are given in good faith and offered for informational purposes only. The publisher and company do not warrant or assume any legal liability or responsibility for the accuracy, completeness, or usefulness of any information and/or images displayed. Yacht inventory, specifications and charter prices are subject to change without prior notice. None of the text and/or images used in this brochure may be reproduced without written consent from the publisher.

- EUFORIA YACHT -