

ANDREAS L





ANDREAS L IN CROATIA

WHAT IS THE GREATEST LUXURY OF ALL?

IS IT RELAXING AT THE END OF THE DAY WITH
A MASSAGE FROM THE ONBOARD THERAPIST,
COCKTAILS IN THE JACUZZI, SUNBATHING ON
THE FORWARD BRIDGE DECK, READING IN THE
ELEGANT SALOON OR ENJOYING THE LENGTHY
LIST OF SPORTS EQUIPMENT?

OR IS IT SIMPLY THE CHOICE TO DO ALL
– OR NONE – OF THE ABOVE? ANDREAS L PROVES
YOU CAN NEVER HAVE TOO MUCH SPACE.

SPACE TO ENTERTAIN, SPACE TO RELAX,
SPACE TO SOCIALISE WITH FRIENDS AND FAMILY,
OR SPACE TO ENJOY TIME ON YOUR OWN.

A DEDICATED CHARTER MANAGER IS ON HAND
TO ANTICIPATE YOUR EVERY NEED AND ENSURE
THAT YOUR STAY IS WHATEVER YOU WANT IT TO BE.

60 METRE ANDREAS L IS ONE OF THE FINEST
BENETTI YACHTS. ADD TO THAT ELEGANT INTERIOR
DESIGN BY REDMAN WHITELEY DIXON AND THE
CONSIDERABLE CHARTER EXPERIENCE OF LIVERAS,
AND YOU HAVE ONE OF THE MOST EXCEPTIONAL
YACHTS IN THE WORLD.





HUGE OUTDOOR AREAS INCLUDE THREE DISTINCT DECK SPACES FOR SUNBATHING OR DINING.

THE SUN DECK HAS A JACUZZI AND A VAST CURVED SUNPAD FORWARD, SEPARATED FROM THE AFT DINING AND SUNBATHING BY A FULLY EQUIPPED, ENCLOSED, AIR-CONDITIONED GYM. FOR A CHANGE OF SCENE, HOW ABOUT THE ENORMOUS SUNPAD FORWARD ON THE BRIDGE DECK? WIND IN YOUR HAIR, SUN ON YOUR FACE, SPECTACULAR VIEW IN YOUR EYELINE. IN ADDITION TO ALL OF THESE SENSATIONAL SPACES THERE ARE COVERED DINING AND SEATING AREAS AFT OF THE UPPER AND MAIN DECK. WHATEVER YOU WANT, WHEREVER YOU WANT: WELCOME ABOARD.





THE SUN DECK MEASURES FIFTY PER CENT OF THE YACHT'S LENGTH. A BEAM OF OVER TEN METRES CREATES ENOUGH SPACE FOR QUADRUPLE SUNPADS BOTH FORWARD AND AFT. EXCEPTIONAL CUISINE PREPARED BY THE TALENTED CHEF IS SERVED ALONGSIDE 270° VIEWS FROM THE SHADED 12 PERSON DINING TABLE.



SUN DECK AFT

THE ILLUMINATED JACUZZI IS LIT BY CHANGING LED COLOURED LIGHTS. SIP A COCKTAIL AT THE SWIM-UP BAR
AS THE BUBBLES PULSE FROM RED TO BLUE, THROUGH GREEN, ORANGE, PURPLE AND EVERY SHADE IN-BETWEEN.





UPPER SALOON



MAIN SALOON

THE CLASSIC-CONTEMPORARY INTERIOR DESIGN
FEATURES WARM-TONED PANELLING IN WENGE AND
ANIGRE, COMPLEMENTING SUMPTUOUS CREAM
FABRICS FOR AN UTTERLY TRANQUIL ATMOSPHERE.
THE LARGE, OPEN MAIN SALOON IS FLOODED WITH
LIGHT FROM FULL-WIDTH WINDOWS.



BY NIGHT THE MAIN SALOON BECOMES AN INTIMATE CINEMA.
SETTLE INTO THE DOUBLE DEPTH SOFAS AND WATCH A MOVIE FROM
THE KALEIDESCAPE LIBRARY ON THE 56 INCH RETRACTABLE TELEVISION.



THE SPACIOUS DINING TABLE CAN SEAT 12 GUESTS.
ANDREAS L HAS BEEN INTELLIGENTLY DESIGNED TO ENSURE THAT
THE DUTIES OF THE CREW NEVER INTERRUPT GUESTS' ENJOYMENT OF THE YACHT.



AFT UPPER DECK

AFT UPPER DECK

THE CÔTE D'AZUR, COSTA SMERALDA OR THE CARIBBEAN – WHEREVER THE BACKDROP, THE STAR ROLE IS PLAYED BY DINNER ON THE ATMOPHERIC AFT DECK. WHATEVER YOUR TASTE – IN FOOD OR THEME – THE DEDICATED CREW WILL MAKE IT HAPPEN.



12 GUESTS ARE COSSETED IN SIX SPACIOUS CABINS. THE FULL-BEAM MASTER SUITE IS ON THE MAIN DECK AND FEATURES TWO BEAUTIFULLY FINISHED MARBLE BATHROOMS, A WALK-IN WARDROBE AND A PRIVATE LOUNGE. WIFI THROUGHOUT THE YACHT ENSURES THAT THE WORLD IS NEVER FAR AWAY, UNLESS YOU WANT IT TO BE.



VIP SUITE



FULL-WIDTH WINDOWS BATHE THE UPPER DECK VIP CABIN IN NATURAL LIGHT.
THIS STRIKING SUITE ADJOINS THE UPPER DECK SALOON. WAKE UP, WANDER OUT
AND ENJOY THE EARLY MORNING PEACE AND QUIET, INSIDE OR ON DECK.

LOWER DECK DOUBLE CABIN



TWO DOUBLE AND TWO TWIN CABINS ARE
SITUATED ON THE LOWER DECK.
THE SAME ELEGANT DESIGN AS THE MASTER
AND VIP CABINS ENHANCES THE FEELING
OF CALM AND SPACE.

TWIN CABIN



UPPER DECK MASSAGE ROOM



SUN DECK GYMNASIUM





SPECIFICATION

LENGTH:	60 METRES / 196 FEET, 10 INCHES
BEAM:	10.4 METRES / 34 FEET
BUILDER:	BENETTI
INTERIOR DESIGNER:	REDMAN WHITELEY DIXON
NAVAL ARCHITECT:	BENETTI
ENGINES:	2 CATERPILLAR 3512B DIT A 1380KW @ 1600HP
CRUISING SPEED:	16 KNOTS
CLASSIFICATION:	LLOYD’S REGISTER / MCA
CREW:	15 / 16
GUESTS:	12

32FT INTREPID TENDER WITH 2 X 250HP,
23FT NOVURANIA TENDER WITH 2 X 90HP,
YAMAHA FZS 4 STROKE JET SKI AND A KAWASAKI JET SKI,
2 X MALIBU OCEAN KAYAKS,
LASER PICO SPORT,
15FT HOBIE SAILING CATAMARAN,
CONCEPT II ROWING MACHINE, 2 X LIFTING BAGS,
3 X WAKEBOARD JOBE, 6-PERSON TOWABLE JOBE,
2 X STAND-UP PADDLE BOARDS, WAKE SKATE,
BEACH CRICKET,
BEACH VOLLEYBALL,
3 X REMOTE CONTROL MODEL LASER SAILING YACHTS,
FENDER PUMP PRO STOCK 220V,
BROIL-MATE BARBECUE ,
3 X SETS OF WATER SKIS, CONNELLY SINGLE SKI,
WETSUITS AND JET SKI JACKETS,
2 X SETS OF DIVE GEAR, MASKS, SNORKELS AND FINS,
WATER TRAMPOLINE, INFLATABLE ICEBERG AND SLIDE,
SHIMANO FISHING EQUIPMENT,
LATEST ENTERTAINMENT AND COMMUNICATION SYSTEMS,
INCLUDING KALEIDESCAPE, WIFI, IPOD DOCKS AND BROADBAND,
STABILIZATION AT ANCHOR, GYMNASIUM AND MASSAGE ROOM.

SUN DECK

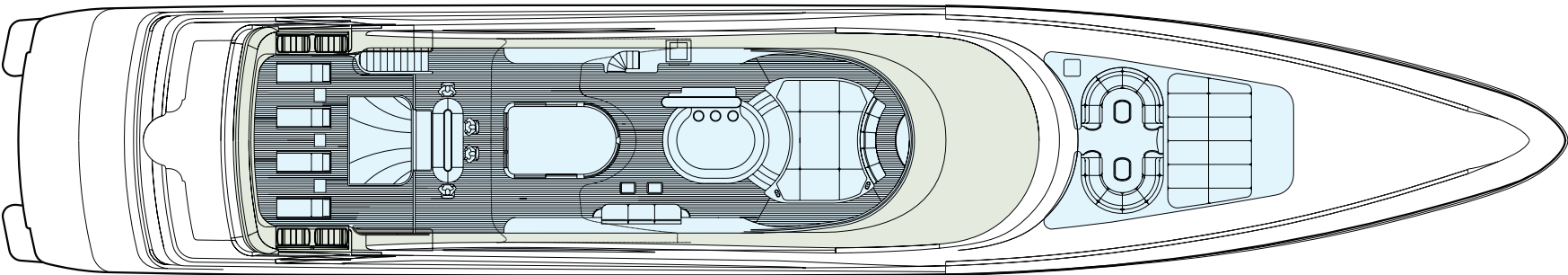

UPPER DECK

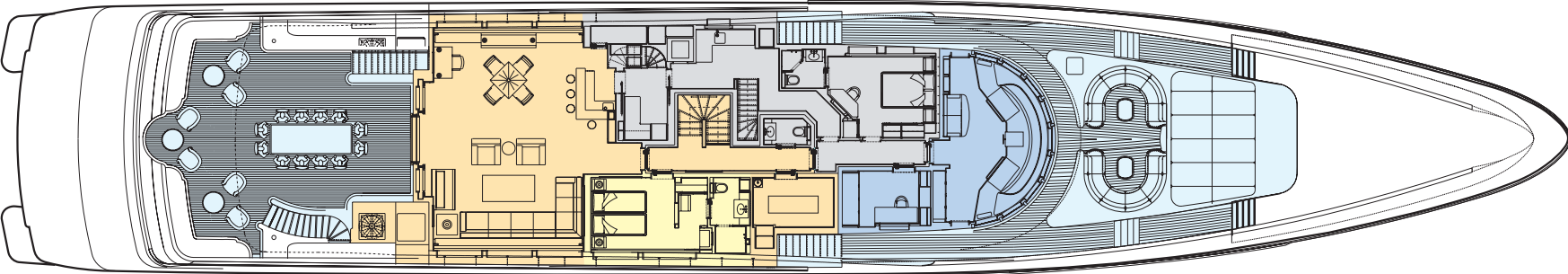

MAIN DECK

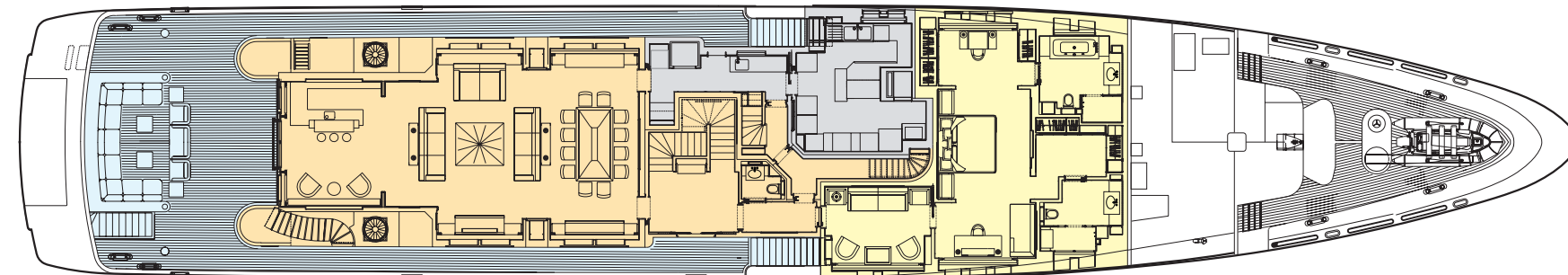

LOWER DECK

